

# Emergency Load Lowering

In the event of power loss and a load is left suspended, the Seatrax crane **hoists** are equipped to allow **emergency load lowering**.

1. Retrieve the **brake release tool** attached to the lower left side of the **boom hoist frame**. (*Note: If tool is missing, a  $\frac{3}{4}$ " UNC threaded rod about 1-foot long with a flat washer and nut can be substituted.*)
2. If **hoist** is equipped with a **secondary shaft brake**, connect a **hydraulic hand pump** to its **release port**. Pressurize to 500 psi to release **brake**.
3. Remove **plug** in top of **brake actuator cylinder**.
4. Install **nut** and **flat washer** on **brake release tool**. Insert **brake release tool** into **brake cylinder** and thread into hole in top of **brake piston**.
5. Slide down **flat washer**, and thread **nut** down until snug.
6. Hold **rod** from rotating while turning **nut** clockwise. This will pull **piston** and **rod** up and releases the **brake**. (*Caution: During this step, tap **brake band** with a hammer to avoid a sudden release.*)
7. As **hoist** begins to turn, turn **nut** counterclockwise to slow it down or stop. Turn it clockwise to release or increase the speed. Do not lower load fast. Lower it slowly.
8. When load has been lowered and released, remove **tool** and replace **plug**.

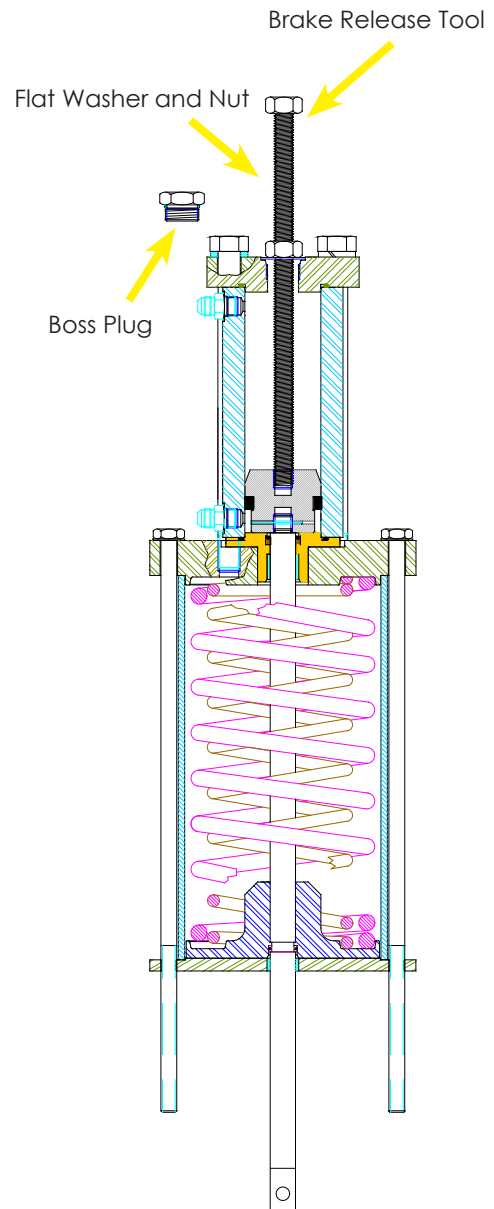

*Note: If the previous steps failed to lower the hoist, remove the **brake release tool**. Remove the **motor control (counterbalance) valve** from **up** line on **motor holding stranded load**. Re-attach **hose** without **valve**, or run **hose** into a large container to catch **hydraulic oil**. Start again from step 1. Replace **counterbalance valve** once load is landed.*